

Template
for Insulating Protective Shutters acc. to DIN VDE 0682 Part 552
for switchgears with voltages up to 36 kV
Material: Hard PVC



① CUSTOMER:

Company: _____

Address: _____

Address, Country: _____

Person in charge: _____

Dept.: _____

Tel.: _____

JSP _____ / _____

Internal Office use only
Please do not complete

SWITCHGEAR:

Type description: _____ Nominal voltage: _____

 Request Order

Qty. of protective shutters: _____

REMARK:

② RECORDED BY:

Name: _____

Date/Signature: _____

Internal notes (please do not fill in)

Person responsible

Dept.	Name	Date	Remark
Service			
Sales			
Purchase			Order No. EK4/

③ CONFIRMATION OF DELIVERY:

The protective shutter(s) has/have been delivered to the above mentioned customer in accordance with the requirements of the template on (date).

This delivery has been subject to random tests in accordance with DIN VDE 0682 Part 552.

 Location, Date

 Stamp/Signature

Template
for Insulating Protective Shutters acc. to DIN VDE 0682 Part 552
for Switchgears with Voltages of up to 36 kV
Material: Hard PVC



JSP ___ / ___

Type of insulating protective shutter

Type/Application

- with finger holes for operation by hand (A1)
- with finger holes for operation by hand (A4*)
- with 1 bayonet pin for working with operating rod (A3)
- with 2 bayonet pin for working with operating rod (A3)
- rotatable shutter for working with operating rod (A3)
- with handle (A2)

*** Note:**

Type A4 – For inserting and removing the shutter, the front of the switchgear itself protects the operator from electrical shocks!

Shutter sizes exceeding 1 m² would require 2 persons for operation!

Thickness:

_____ mm

Colour:

Type/Inserting

- Standard type (insertable into guide rails, 9030)
- Insert allows for rotation of the shutter (by bearing pin guide)

Type of insulating protective shutter

A1: 763 211

A2: 763 221

A3: 763 231

A4: 763 241

Dimension:

B _____ mm

L _____ mm

L_s _____ mm

H _____ mm

γ _____ The angle of the handle can be selected for angles between 70° to 290°.

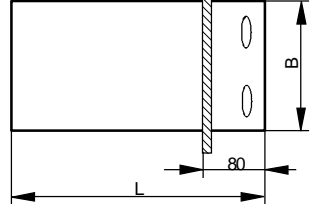
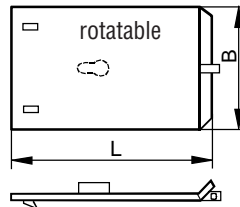
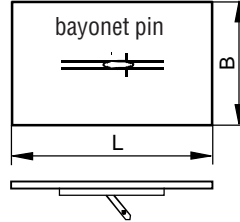
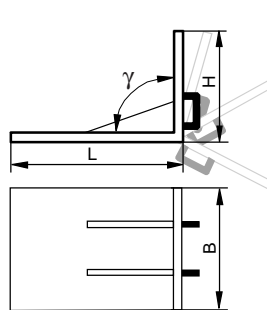
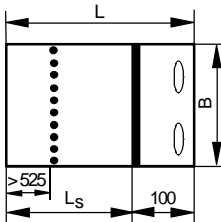

Additional sketch for different types

x₁ Rear left corner (panel format)

x₂ Rear left corner (landscape format)

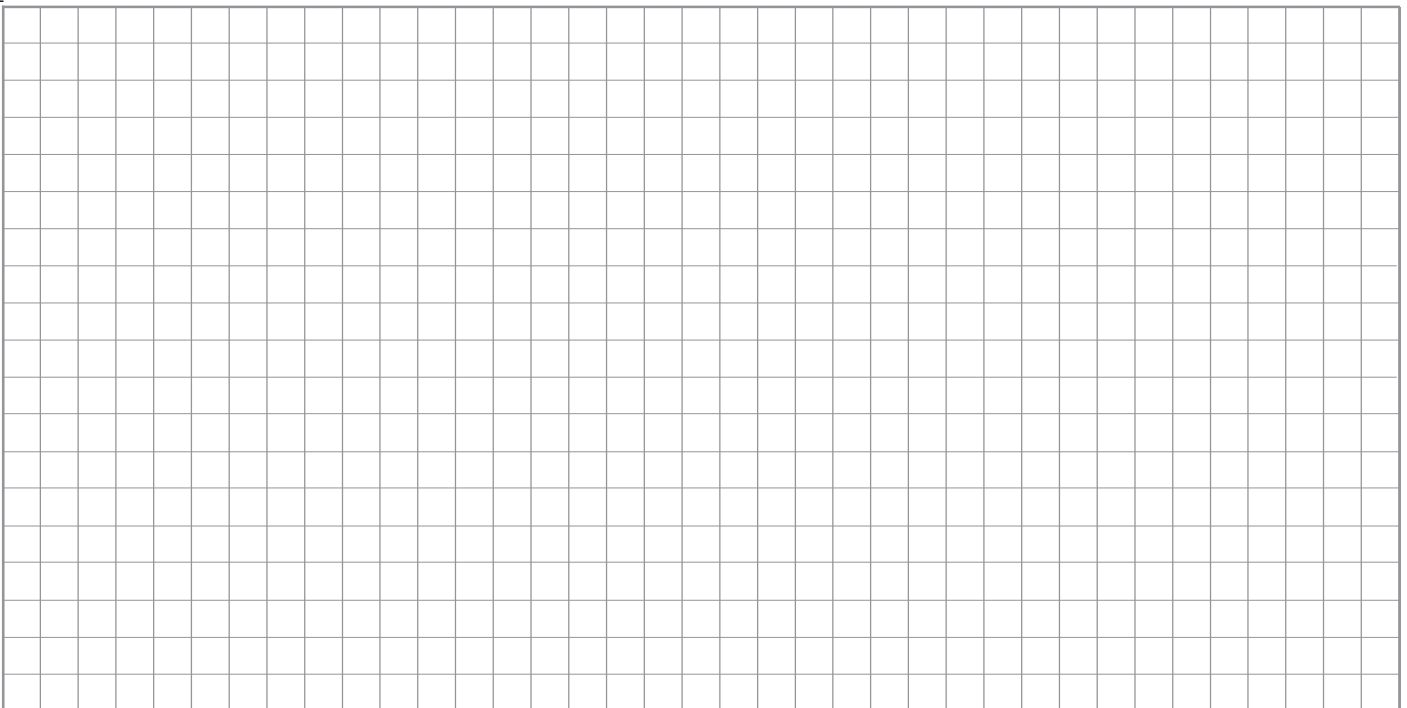

x₁

Template
for Insulating Protective Shutters acc. to DIN VDE 0682 Part 552
for Switchgears with Voltages of up to 36 kV
Material: Hard PVC



Accessories

Guide Rails
9030

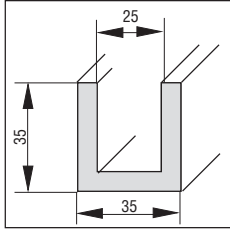

Bayonet Pin
9040

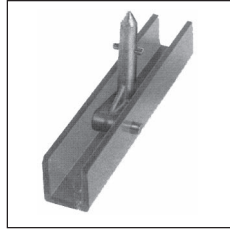

Bearing Pin
9010 / 9020

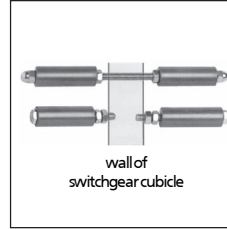

Magnetic Support
9060

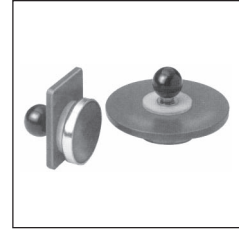

Supporting Device
9070 / 9080

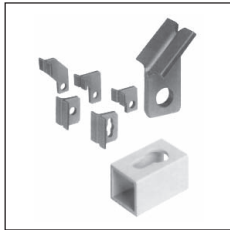

Handle
9050



Ball Bearing

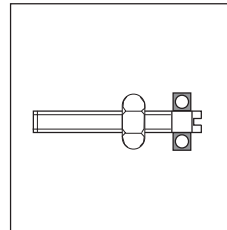

Type	Length (in mm)	Pieces

Insulating rod for voltages up to 36 kV

with cone coupling
for swivel pin

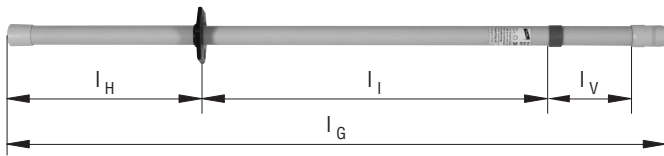

Switching rod for voltages up to 36 kV

for slotted shutters

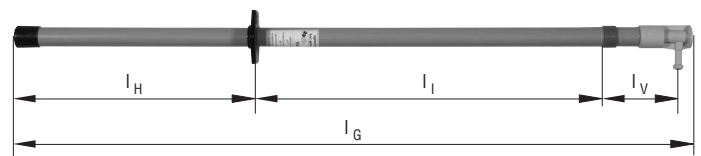

Nominal voltage	l_G	l_I	l_H	l_V	Part No. of insulating rod	Part No. of switching rod
up to 36 kV	1028 mm	525 mm	350 mm	140 mm	766 311	
up to 36 kV	1528 mm	525 mm	500 mm	490 mm	766 315	
up to 36 kV	2028 mm	525 mm	600 mm	890 mm	766 320	
up to 36 kV	1030 mm	525 mm	370 mm	115 mm		763 610
up to 36 kV	1500 mm	525 mm	550 mm	395 mm		763 611
up to 36 kV	2000 mm	525 mm	700 mm	745 mm		763 612

Other lengths available on request!